



Garden of Plenty Sustainable Living

Bloom 2013
Phoenix Park, Dublin

SPONSORS

The project is a unique venture as it is the first time that the forestry and wood industries have collaborated with horticulturists and nurseries to produce an exhibition showcasing the best in sustainable wood and food production. Sincere thanks to the following sponsors for their support:

Wood Marketing Federation

Department of Agriculture, Food & the Marine

Murray Timber Group

Coillte Panel Products

Flannery's Nurseries Ltd

Laois Sawmills Ltd

Lonza Wood Protection

CONTENTS

- 3 Garden of plenty
- 5 Wood culture
- 7 Community resource
- 9 Garden space
- 11 Wood space
- 12 Exhibiton map
- 14 Team effort
- 16 Profiles

Garden of Plenty – Sustainable Living

The flocks of green potato-stalks
Were blossom spread for sudden flight,
The Kerr's Pinks in a frivelled blue,
The Aran Banners wearing white.

And over the potato-field
A lazy veil of woven sun.
Dandelions growing on headlands, showing
Their unloved hearts to everyone.

Patrick Kavanagh from *Spraying the Potatoes*

Bloom 2013
Phoenix Park, Dublin
30 May – 3 June 2013

GARDEN OF PLENTY

Sustainable Living

Sustainability is the core message of *The Garden of Plenty*. It applies to the rich variety of plants grown for the exhibition along with the wood that supports and shelters the garden. Sustainable development is the wise use of resources to meet the present and future needs of society.

In forestry it acknowledges the continuum in the growing cycle from seed fall to tree fall and the need to maintain the link between forests past, forests present and forests future. The same principle applies to farming and gardening regardless of scale; from large intensive farms to plots as small as *The Garden of Plenty*.

Small-scale gardening is not new in Ireland. Less than a couple of generations ago a high percentage of the population had gardens even in urban areas. These were highly productive. For example an area of little over one fifth of a hectare can produce two tons of food annually according to John Feehan in *Farming in Ireland*, far more food per unit area than intensive farming.

There is of course a place for both. "Farming of the future will have to be more, not less scientific, but the science must be applied to the land in a more intelligent, holistic, ethical and sustainable way," according to Feehan. The word 'sustainable' recurs because it has real meaning when applied to land use.

Both forestry and agriculture are multipurpose resources where food and wood production are the main but not the only objectives. Both also have social and environmental benefits when practised sustainably.

Opposite: Pergola at 8th Festival Internacional de Jardins de Ponte de Lima, Portugal.

Below: Lettuce plants in foreground and broad beans sown for Bloom 13 in raised beds.



WOOD CULTURE

The Garden of Plenty is one of a series of projects between Woodcollective and the Wood Marketing Federation (WMF).

Sustainable living has been a constant theme in all these collaborations. All projects to date have involved the promotion of wood and wood products sourced from sustainably managed forests including trade fairs such as PlanExpo and the Woodspace installations at the annual musical festival Electric Picnic.

Both organisations have been working towards a partnership involving other aspects of sustainable living including renewable energy and food production.

These are compatible with the aims of both WMF and Woodcollective: the ideas underlying the garden are layered like the soil that feeds it and the sustainable wood that supports and encloses it. The project links the forest and the garden by drawing on cyclical themes and natural systems on which both depend for growth and regeneration.



Left: Woodspace - Forest of Light at Electric Picnic 2012 in Strabally.

Right: Amhaidoireacht, Bergen, Norway, 2006.

COMMUNITY RESOURCE



Small-scale gardening is enjoying a renaissance in Ireland.

The Garden of Plenty – Sustainable Living demonstrates the potential of a small interpretative and productive garden. Designed by the architect Eugene Boyle, Woodcollective, the original conceptual planting plan was developed by Carol Melody and Paul Cox of Annapura Garden Design for the 8th Festival Internacional de Jardins de Ponte de Lima, Portugal. The garden (left) was voted best design by an overwhelming majority of the 100,000 visitors.

Woodcollective decided to collaborate with the Wood Marketing Federation to bring phase two of *The Garden of Plenty* to Ireland. They enlisted the help of a diverse group involved in horticulture, wood processing, woodworking and craft to create a garden for an Irish environment and audience. Eugene Boyle's approach is both poetic and pragmatic; functional and aesthetic:

There is a poetic, educational and sensory dimension in its design and realisation. The garden is very much a journey of learning through a series of places and spaces from landscape to inner court, from public to private. The lime plastered wall nods towards qualities provided by traditional permanent walled gardens. The sinuous solid form alludes to residential scale, settlement in landscape and anchors the scheme. The intention is to inspire and encourage social infrastructure which can empower community development. The potential for social connection, community resilience and multigenerational access are at the heart of the project.

The design is demountable and transportable. We are open to the idea that the garden could be rebuilt in other locations or perhaps even given a permanent home as a public or community resource.

Garden space

There is a strong collaboration element to the project especially in the supply of the main constituents of the garden.

The Garden of Plenty is located close to the Victorian walled kitchen garden in the Phoenix Park. It contrasts with the walled garden, which is a permanent space, but there are many similarities. Both inspire and educate the public about sustainable living and the growing of garden plants including fruit, vegetables, herbs and flowers.

Padraig O'Shaughnessy of Aqua Landscapes is at ease in both temporary and permanent garden spaces - his love for horticulture began when he restored a walled garden on the family farm.

Plants were provided by Aqua Landscapes and Flannery's Nurseries. Padraig and Louise O'Shaughnessy of Aqua Landscapes began growing the vegetables and herbs for the exhibition as early as January and despite the prolonged cold spring, all plants are in place for Bloom.

Left: Garden elements – fruit and vegetables (Aqua Landscapes and Flannery's Nurseries); eased edged planed spruce (Murray Timber Group); bark mulch (Laois Sawmills); OSB (Coillte Panel Products); and seating (Pat Staunton).

Right: Victorian Walled Garden, Phoenix Park.





Wood space

The timber supplied for the garden was sourced in sustainably managed forests.

The forestry and forest products industry is a major contributor to rural development. Forests established over the past century have attracted a vibrant timber industry often close to the oldest and most established raw material base.

This is true of all the timber suppliers to the *Garden of Plenty*. The Murray Timber Group (MTG) headquarters is located close to Ballygar forest one of the earliest and most productive forests purchased by the State in 1910. Their highly finished timber has transformed the sawn timber market in Ireland and abroad and is a strong component of the garden.

Likewise, Laois Sawmills is based close to the productive Slieve Bloom forests. This innovative mill produces a wide range of garden products, fencing and wood pellets for the renewable energy market as well as bark mulch for *The Garden of Plenty*.

The two mills owned by Coillte Panel Products in Waterford Port and Clonmel have a rich vein of forest produce at their disposal. They export medium density fibreboard (MDF) and oriented strand-board (OSB) around the world. Coated OSB is used as shelter for *The Garden of Plenty*.

It is no coincidence that the intricate woodwork would be carried out in the heart of Wicklow, a county with a strong unbroken wood culture. The tradition of skilled timber workmanship is a hallmark of John Staunton (Glenealy) Ltd.

Work on pergola, trellis and courtyard, supervised by Eugene Boyle.

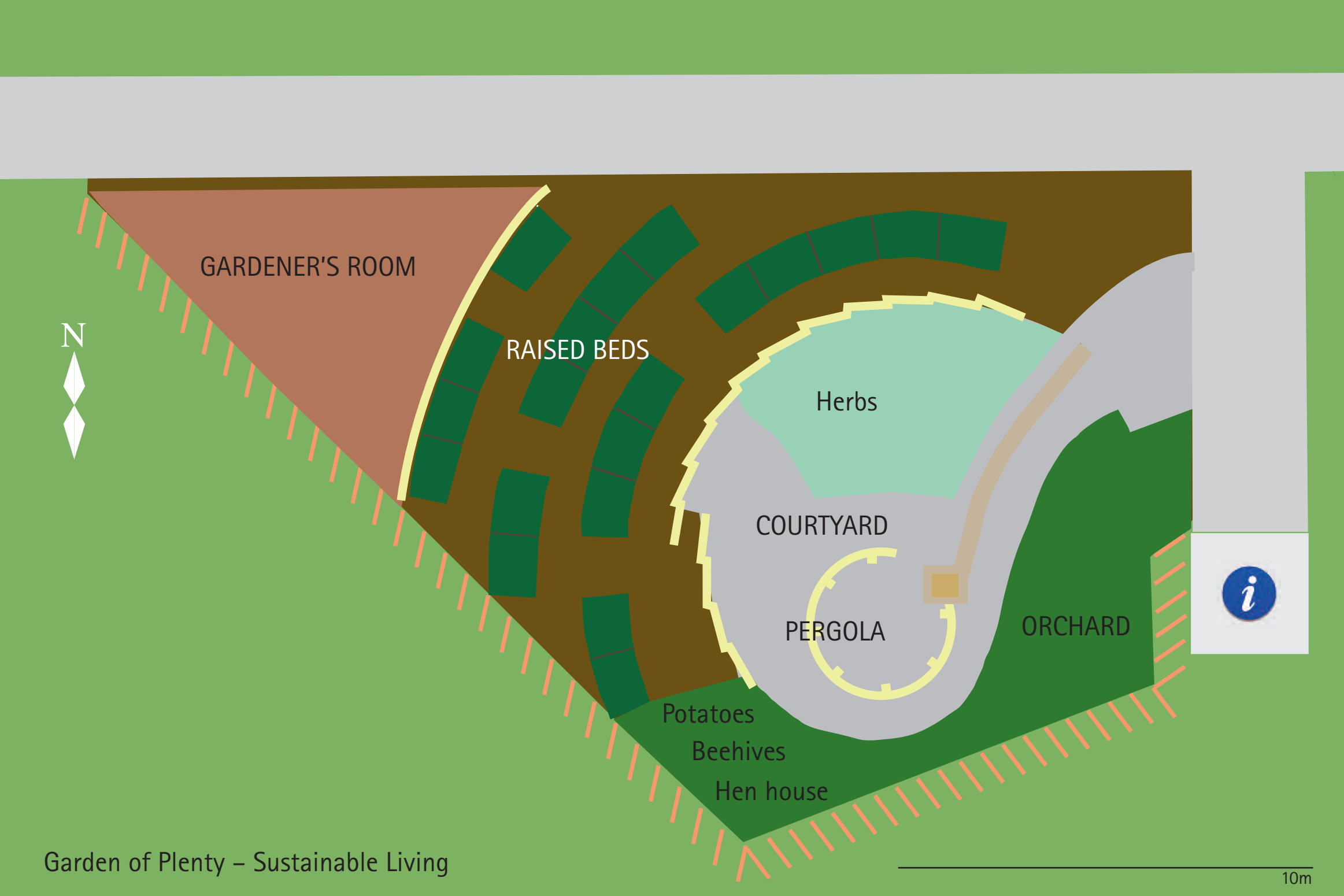

COURTYARD **RAISED BEDS**

- Camomile
- Rosemary
- Fennel
- Lavenders
- Oregano – normal/golden/variegated
- Feverfew
- Horseradish
- Comfrey
- Borage
- Angelica
- Common mint
- Spearmint
- Marjoram
- Artichoke
- Sage
- Lemonbalm
- Thyme – normal/golden
- Chives

- Beetroot
- Broad beans
- Broccoli
- Cabbage
- Carrot
- Cauliflower
- Celeriac
- Celery
- Climbing beans
- Courgette
- Kale
- Kohlrabi
- Leek
- Lettuce
- Onions
- Pak Choi
- Pea
- Radish
- Red Cabbage
- Spinach
- Spring onion
- Squash
- Sunflowers
- Swede
- Swiss chard

ORCHARD

- Apple
- Cherry
- Pear
- Plum
- Fig
- Blueberries
- Gooseberries
- Redcurrants
- Blackcurrants
- Rhubarb
- Strawberries
- Pineberries
- Potatoes

TEAM EFFORT

The construction and installation of *The Garden of Plenty – Sustainable Living* employed the best of Irish craft, crop husbandry and technology in a sustained team effort.

The Wicklow based company John Staunton (Glenealy) Ltd played a major role in pushing the boundaries of woodwork and construction in their use of traditional sawn timber and engineered wood products. All their staff displayed a high degree of skill and co-operation at all times. We thank all the Glenealy team including John, Paul and Anne Staunton.

Our thanks to timber suppliers for their patience especially the Murray Timber Group, Coillte Panel Products and Laois Sawmill who provided a wide range of wood products at the required – and often complex – specifications.

Thanks to Oliver Hoey of Building Concepts, Dublin for his help in the construction of the gardener's room. Special thanks to Edward Byrne of the Traditional Lime Company, Tullow, Co. Carlow for supply of lime and sand materials and for organising the lime plastering of the sculptural wall feature in the project.

The supply of plants and the planning and installation of the various 'green' areas was carried out by Aqua Landscapes with generous support from Flannery's Nurseries

The Garden of Plenty – Sustainable Living is a collaboration between the following organisations, companies, communities and individuals who worked tirelessly to bring the project to fruition:

Designer: Eugene Boyle, Woodcollective-Meitheal Adhmaid

Project co-ordinator: Donal Magner, Wood Marketing Federation

Plant sourcing, layout: Padraig & Louise O'Shaughnessy, Aqua Landscapes

Horticulture consultant and designer (Phase 1): Carol Melody

Suppliers

Murray Timber Group, Ballygar, Co. Galway & Ballon, Co. Carlow, Coillte Panel Products, Waterford Port and Clonmel, Laois Sawmills, Stradbally Road, Portlaoise, Co. Laois, The Traditional Lime Company, Tullow, Co. Carlow, Gunnings Concrete, Kildakey, Co. Meath, Summerhill Lawns, Summerhill, Co. Meath, Keegan Quarries, Trammon, Rathmoylon, Co. Meath, Decker Horticultural Supplies, Trim, Co. Meath, Pat Staunton, Sawmill, Glenealy, Co. Wicklow, Lusks Garden Centre, Kilyon, Co. Meath AB Hire, Trim Co. Meath.

Planning, construction installation

Contractors: John Staunton Ltd (Glenealy), Co. Wicklow
Aqua Landscapes, Ballivor, Co. Meath

Preconstruction

Planning and advisory: Shay O'Neill, Hollywood Timber Products, Hollywood Rath, Dublin

Construction

John Staunton Ltd (Glenealy), Co. Wicklow, Eugene Boyle, Woodcollective, Oliver Hoey, Building Concepts, Dublin, Edward Byrne, The Traditional Lime Company, Tullow, Co. Carlow.

Support: Fergus Gohery, Francis Mc Brearty, Naoise O'Baoghill Galla-choir, Paul Shorten, Nessa O'Shaughnessy, Aidan Burke, Carol Melody, Lawrence Kiernan, Clare O'Shea, Graham Morrissey, Ronan Herron, Vasco Reis, Mark Field, Peter O'Toole.

The project is indebted to the following people for support: Paul Harvey, Chairman WMF, Patrick Murray and Louis Coleman (Murray Timber Group); Richard Lowe, Coillte; Neil Foot and Nick Marron (Coillte Panel Products); Anne Staunton, Paul Staunton, John Staunton (J. Staunton (Glenealy) Ltd); Jim McNamara and Rory Roberts (Laois Sawmills) and Mark Walsh (Aqua Landscapes).

Presentation

3-D representations: John Healy, Digital Dimensions Architectural and Environmental Visualisations, Dublin.

Design and Working Drawings: Eugene Boyle and Ray Melvin, Melvin Architectural Services, Dublin.

Printing: Paddy Cribben, Colour Copy Centre, Pembroke St Upper, Dublin 2.

Photography

Iris Rocha & Andre Taveras, Porto Portugal (Photography at 8th Festival Internacional de Jardins de Ponte de Lima, Portugal 2013).

Donal Magner, Magner Communications

Eoin O'Driscoll, Drima Marketing

Brochure

Editor: Donal Magner

Design: Grasshopper Graphics

Finally, thanks to the staff at Board Bia for their support.

Wall carcassing in OSB and planed spruce before Traditional Lime Company applied lime plastering.

PROFILES

Eugene Boyle

Eugene Boyle of Woodcollective has conceived and produced collaborative design works in Ireland and overseas since 2006. The work and its educational foundation draw strongly on place making, sustainable design and landscape-conveying ideas and techniques for adaptation and interpretation to different scales and contexts.

An architect by training, he has worked for 20 years in multi-disciplinary design practice. His creative approach fuses art design and craft influences and his collaborations with those spheres has facilitated a dynamic forum for inspiration and invention in design of the built environment and visual arts. He is visiting studio tutor at Dublin School of Architecture, Dublin Institute of Technology, Dublin. Exhibitions include annual collaborations with Wood Marketing Federation at Electric Picnic, Bergen Norway International Wood Festival and Festival Internacional de Jardins, Portugal.

Padraig O'Shaughnessy

A widely respected horticulturist and landscape designer, he has 15 years experience in the industry. After completing a diploma in horticulture in Kildalton College, he worked for Fountains and Decor for four years before setting up his own company. He is a specialist in water feature design and build as well as developing low maintenance gardens for a wide client base. Since moving to Co. Meath he has established a bountiful fruit and vegetable garden. All the vegetable and salad crops for Bloom were grown in the family garden. He acknowledges the generous support of Flannery's Nurseries, Staplestown, Co. Kildare who supplied the trees and large herbs.



Carol Melody

Carol Melody has a degree in Agricultural Science (Horticulture) from University College Dublin. She is currently studying for a PhD entitled 'Soil biology and residue management for low carbon land uses', with particular interest in earthworms and their beneficial effects on soil functioning.

She has been a major contributor to *The Garden of Plenty* especially in Phase 1 when she developed the project with Eugene Boyle for the 8th Festival Internacional de Jardins de Ponte de Lima, Portugal 2012.

Donal Magner

Donal Magner is a forester, author, journalist and secretary of the Wood Marketing Federation. He formed Magner Communications in 1993 after a career in forest management with the Irish Forest Service and Coillte. He holds a Masters Degree in forestry from University College Dublin and is the author of the critically acclaimed *Stopping by Woods – A Guide to the Forests and Woodlands of Ireland*.

He is the forestry editor of *The Irish Farmers Journal* and has co-edited a number of publications including *Glimpses of Irish Forestry* and *Woodspec – A Guide to Designing, Detailing and Specifying Timber in Ireland*, the specialist design manual for architects, designers and engineers.

A past chairman of the forestry group in IBEC and Sculpture in Woodland, he received the Royal Dublin Society-Forest Service Special Award in 2012 for his contribution to forestry in Ireland.

Construction of Garden of Plenty for Bloom 2013 by Paul Staunton and his team. Planting of raised beds by Aqua Landscapes.

Front cover: Padraig O'Shaughnessy, Aqua Landscapes plants lettuces, fennel and broad beans in the raised beds in the Garden of Plenty – Sustainable Living in preparation for Bloom 2013.

Back cover: View of pergola through trellis constructed from a variety of sawn timber, supplied by the Murray Timber Group.

Wood Marketing Federation

The Federation's mission is to promote wood as a renewable, sustainable and versatile natural material. It acknowledges the growing interest in wood use and design and the role that this renewable resource is playing in sustainable living. Programmes such as the annual third level student wood awards are designed to increase the knowledge and understanding of wood and wood products. Exhibitions, seminars and publications promote and encourage new uses and applications for wood by architects, designers, engineers and other specifiers. Exhibitions include PlanExpo and Timber Expo, while publications such as *Woodspec – A Guide to Designing, Detailing and Specifying Timber in Ireland* are aimed at architects, designers and engineers working in wood.

w www.wood.ie
e info@wood.ie or donalmagner@eircom.net

Directors: Paul Harvey (chairman), Michael Lynn, Gerard Murphy, Roy Dempsey. Secretary: Donal Magner.

Woodcollective–Meitheal Adhmaid

Inspired by ongoing collaborative works with wood, Woodcollective seeks to offer and facilitate a forum for sources of inspiration and invention, to draw attention to wood as a building material with a goal to develop the perception, usage and a visibility of the material in new and innovative ways. Woodcollective has produced collaborative works in Ireland and overseas since 2006, conveying ideas and techniques for adaptation and interpretation to different scales and contexts. *The Garden of Plenty* is one of many projects which also include exhibitions in Norway, Germany and Portugal as well as the Woodspace exhibitions at Electric Picnic (2006–12).

w woodcollective.ie
e info@woodcollective.ie

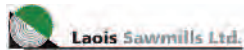

FLANNERY'S
NURSERIES

